

CENTRAL PARKING DISTRICT
PARKING LOT
AT
CHANNEL STREET & HUNTER STREET

Site P

SHEET INDEX

Sheet No. 1 Topography Map
Sheet No. 2 Parking Lot Plan
Sheet No. 3 Electrical and Sprinkler Plan
Sheet No. 4 Landscaping Plan
Sheet No. 5 Cross Sections

CENTRAL PARKING DISTRICT

Approved By Ed Coy
Ed Coy, Manager
Date 11-30-76

SAN JOAQUIN COUNTY

Approved By [Signature]
Chairman, Board of Supervisors
Date 11-30-76

CITY OF STOCKTON

Approved By [Signature]
Thomas J. Dosh
City Engineer
Date 11-30-76

Central Parking District
Channel & Hunter Sts
2312C

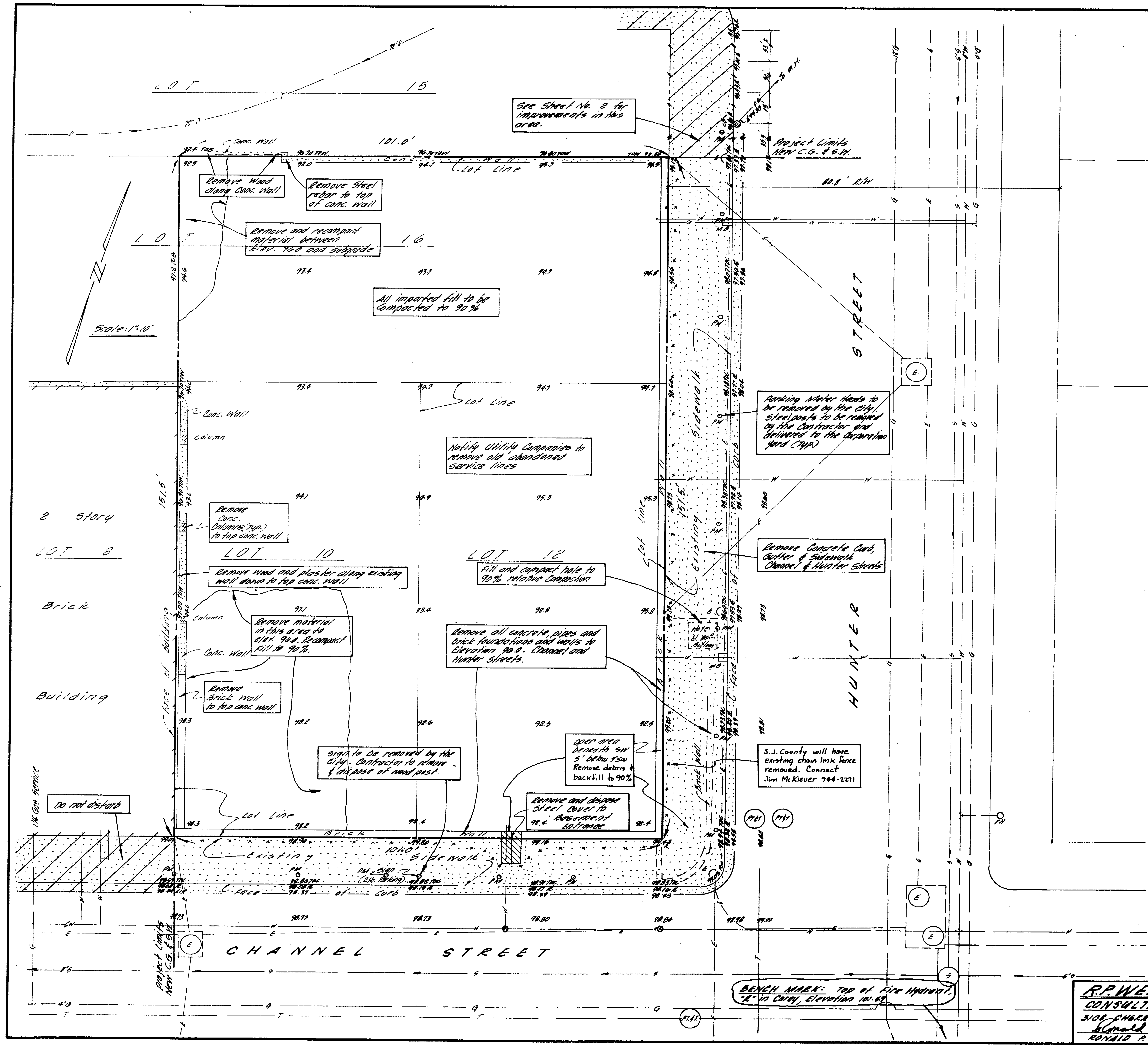

NOTES

- Elevations refer to City of Stockton Datum. Bench Mark Top of Fire Hydrant, "E" in Corey, Elevation 101.49, S.E. Corner Channel St. & Hunter St.
- The underground utilities as shown were plotted from Utility Company records and City of Stockton records. R.P. Weldum & Associates assumes no responsibility for the accuracy of said records.

LEGEND

---	Property Line	91.43	Existing Elevation
—W—	Water Main	91.83-700	Existing Elev. Top of Curb
—G—	Gas Main	92.10 E	Existing Elevation Flowline
—S—	Sanitary Sewer	92.4	Existing Elevation Ground
—D—	Storm Drain	92.4	Parking Meter
—T—	Telephone line	E	Streetlight
—E—	Electrical line	2.4	Fire Hydrant
x	Chain link fence	M.B.	Water Box

SHEET INDEX

Sheet No. 1	Topography Map
Sheet No. 2	Parking Lot Plan
Sheet No. 3	Electrical and Sprinkler Plan
Sheet No. 4	Landscaping Plan
Sheet No. 5	Cross Sections

CENTRAL PARKING DISTRICT
 PARKING LOT
 CHANNEL STREET & HUNTER STREET
 TOPOGRAPHY MAP

R.P. WELDUM & ASSOCIATES, INC.
 CONSULTING CIVIL ENGINEERING
 3104 CHARLEYLAND AVE. STOCKTON, CALIFORNIA
 RONALD R. WELDUM
 R.C.E. NO. 16835

SCALE: 1" = 10'	APPROVED BY: DATE	SHEET NO.
DES. BY: R.P.W.	11.30.76	1
DR. BY: D.E.B.		OF 5 SHEETS
TRACED BY:		125-00
CHECKED BY: R.P.W.		

23/21C G-14

Parking Lot - P. Channel 23/21C
 Director, Topography Map
 MADE IN U.S.A.

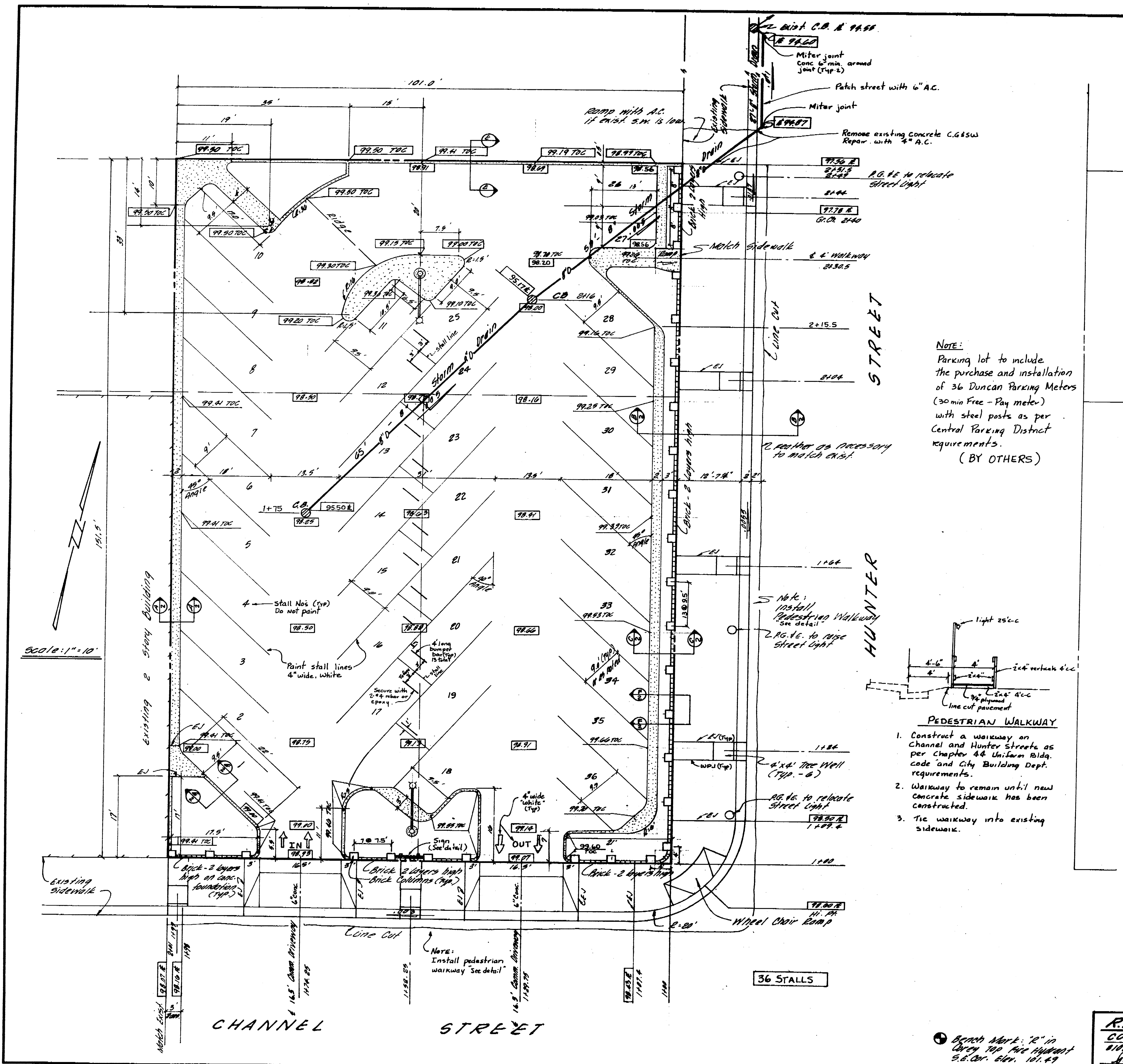

NOTE:
 Parking lot to include the purchase and installation of 36 Duncan Parking Meters (30 min Free - Pay meter) with steel posts as per Central Parking District requirements.
 (BY OTHERS)

HUNTER STREET

CHANNEL STREET

36 STALLS

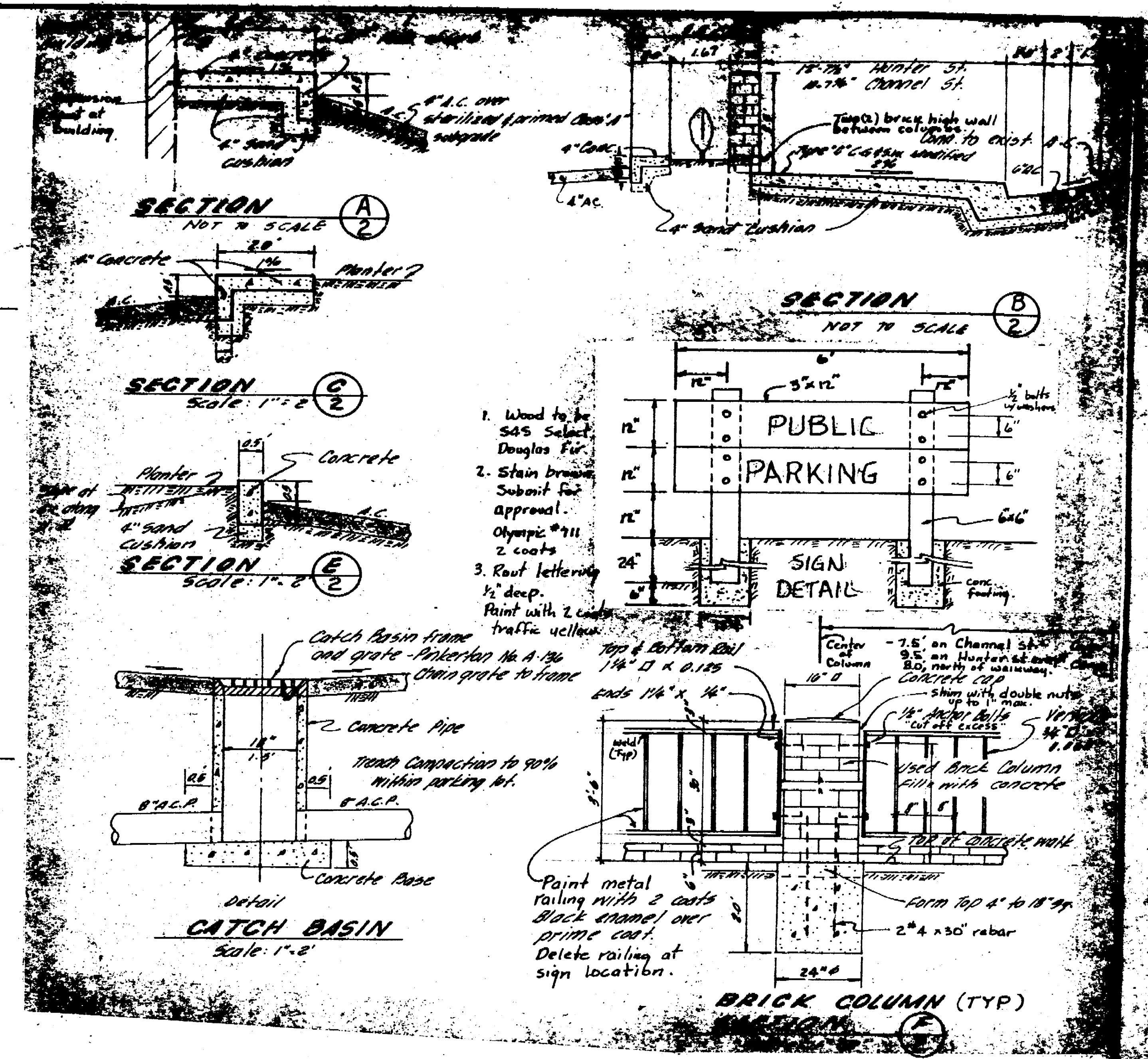

- NOTES**
- Elevations refer to City of Stockton datum. Bench Mark, Top of Fire Hydrant, "B" in Corey, Elevation 101.49, S.E. corner Channel St. & Hunter St.
 - All construction to be in strict accordance with City of Stockton Standard Spec's (1972)
 - Parking lot pavement section, 4" deep bit asphalt concrete over 4" subgrade. Subgrade to be stabilized with 4% to 5% cement per 100 sq. ft. of CaSO₃ W-51. Asphalt concrete to be Type "B" 3/4" max. medium grading & AC 4000 asphalt.
 - All concrete shall be Class "B". Place (2) parts of liquid dispersed lampblack per cu. yd.
 - All areas to receive asphalt concrete.

LEGEND

---	Property Line	99.49	Existing Elevation (See Sheet 1)
W	Water Main	99.85 TOC	Finished Elevation Top of Curb
G	Gas Main	98.14 E	Existing Elevation Flowline
S	Sanitary Sewer	98.4	Existing Elevation Ground (See Sheet 1)
D	Storm Drain	98.47	Finished Parking Grade
T	Telephone Line	98.82	Finished Flowline Grade
E	Electrical Line		
→	Drainage Arrow		

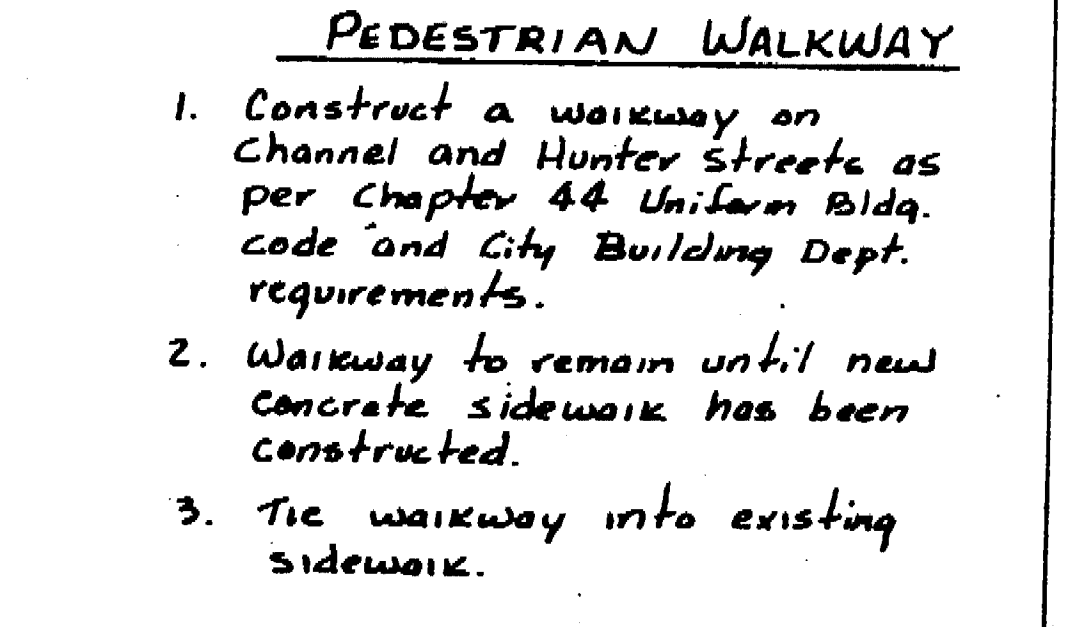

- PEDESTRIAN WALKWAY**
- Construct a walkway on Channel and Hunter Streets as per Chapter 44 Uniform Bldg. Code and City Building Dept. requirements.
 - Walkway to remain until new concrete sidewalk has been constructed.
 - Tie walkway into existing sidewalk.

**CENTRAL PARKING DISTRICT
 PARKING LOT
 CHANNEL STREET & HUNTER STREET
 PLAN**

DEPARTMENT OF PUBLIC WORKS
 CITY OF STOCKTON, CALIFORNIA

R.P. WELDMAN & ASSOCIATES, INC.
 CONSULTING CIVIL ENGINEERING
 517 CHESTLAND AVE. STOCKTON, CALIFORNIA
 Ronald P. Weldman
 RONALD P. WELDMAN E.C.E. NO. 10889

SCALE 1"=10'
 DESIGNED BY R.P.W.
 DRAWN BY D.R.B.
 CHECKED BY R.P.W.

APPROVED BY: DATE 11-30-76
 SHEET NO. 2
 OF 25 SHEETS
 JOB NO. 125-00

2312.20-14

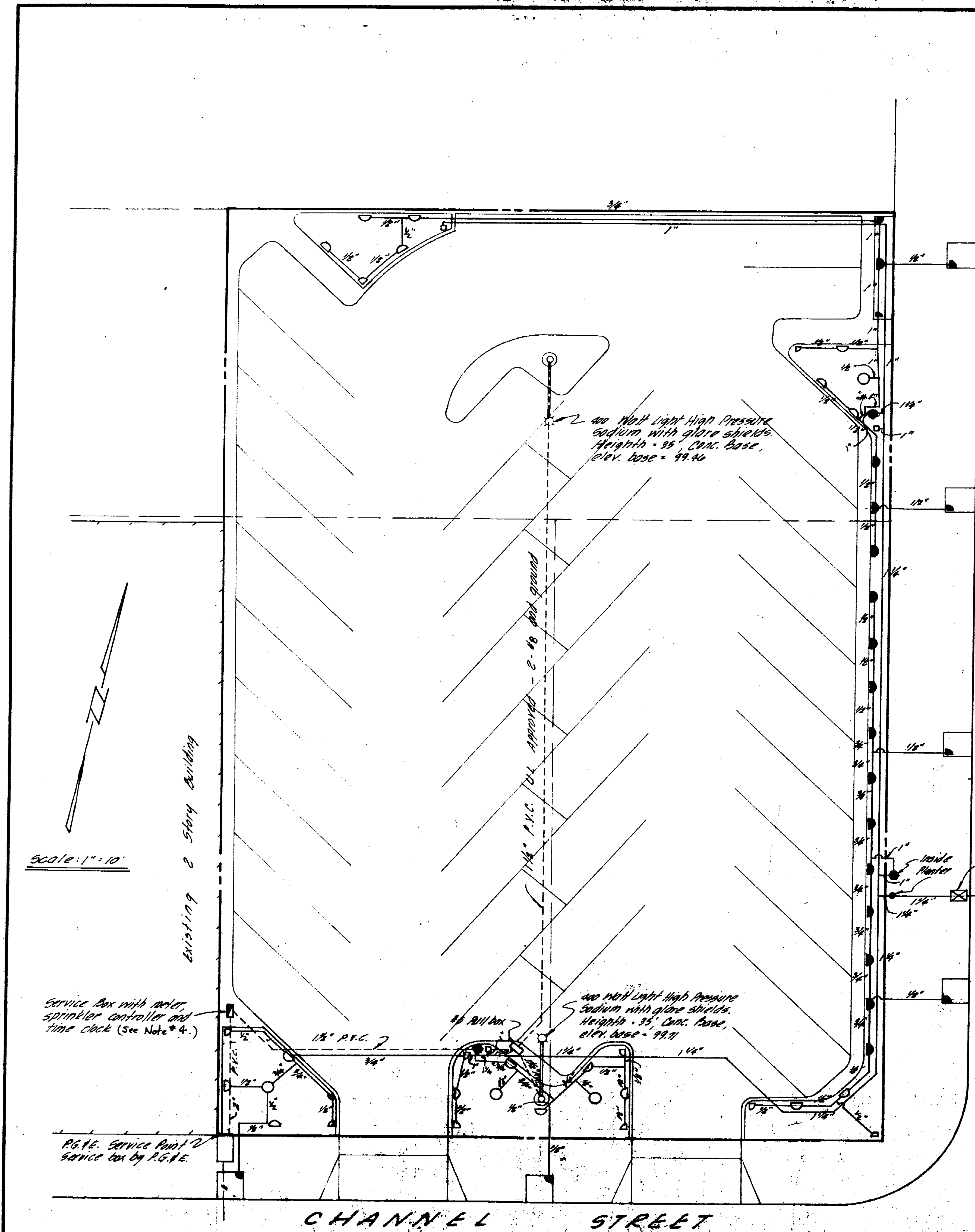

Scale: 1"=10'

EXISTING 2 STORY BUILDING

Service Box with meter, sprinkler controller and time clock (See Note #4.)

NOTE: SERVICE PANEL TO BE PROVIDED BY R.C.P.E.

CHANNEL STREET

HUNTER STREET

Water & Box furnished and installed by City Water

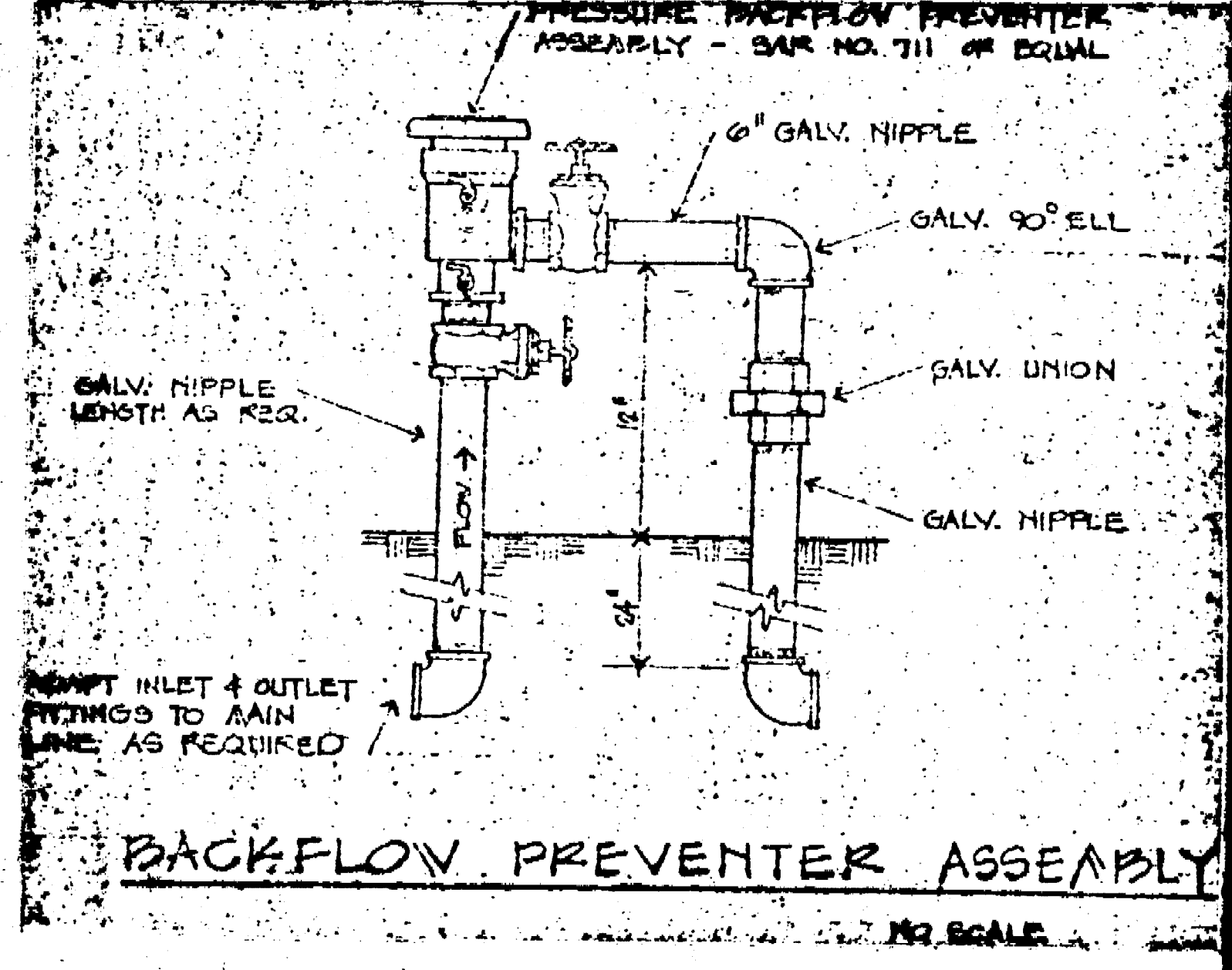
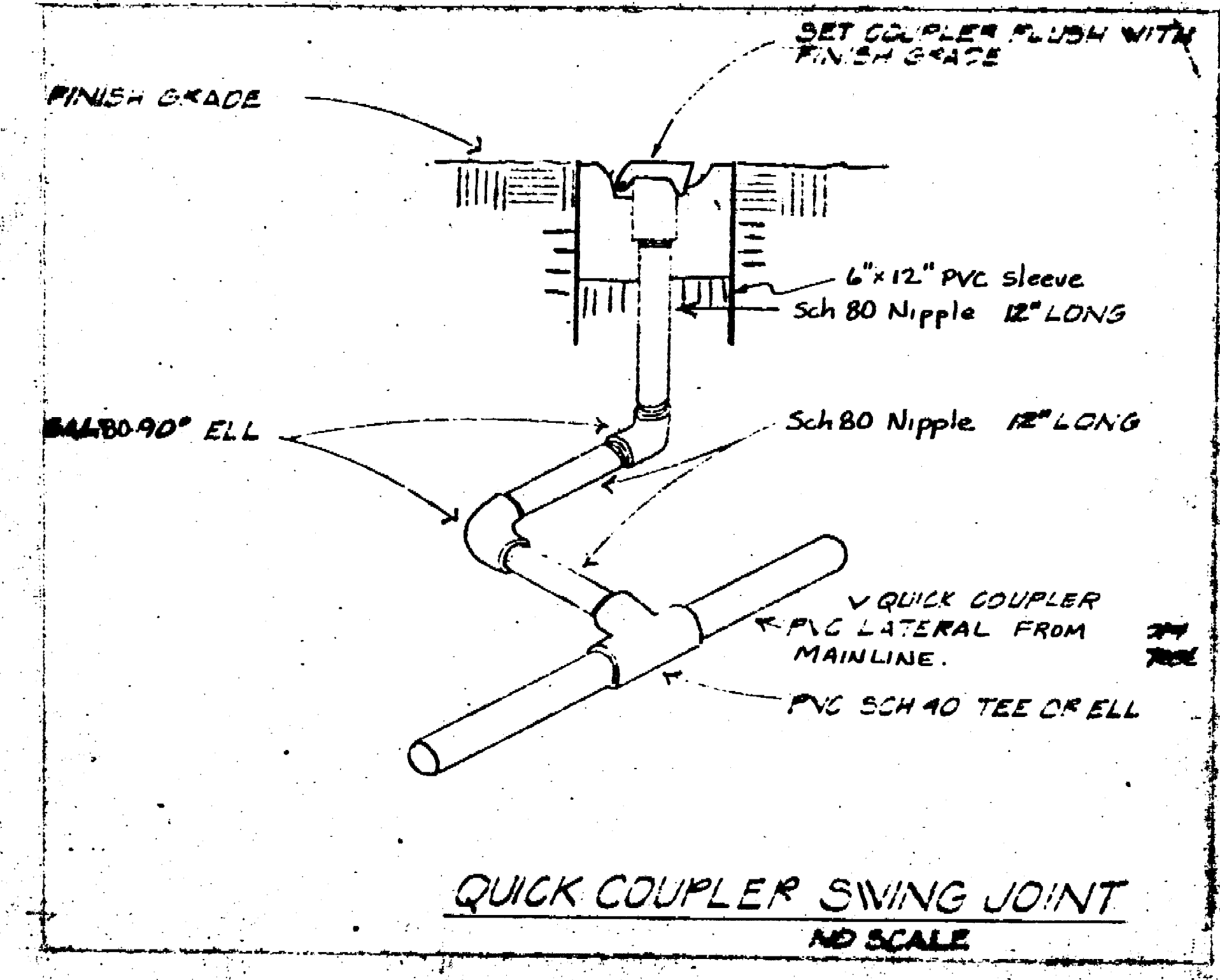
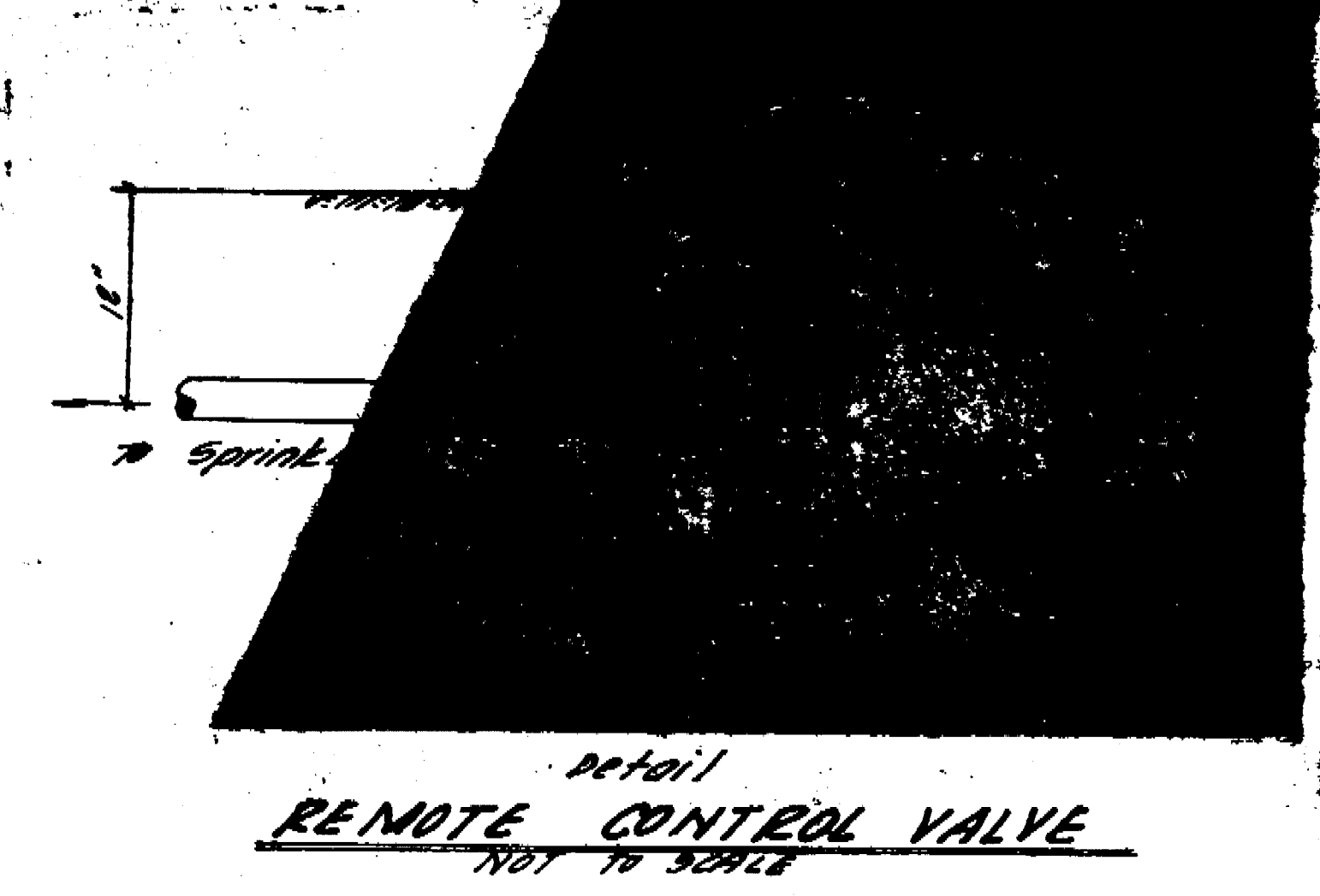
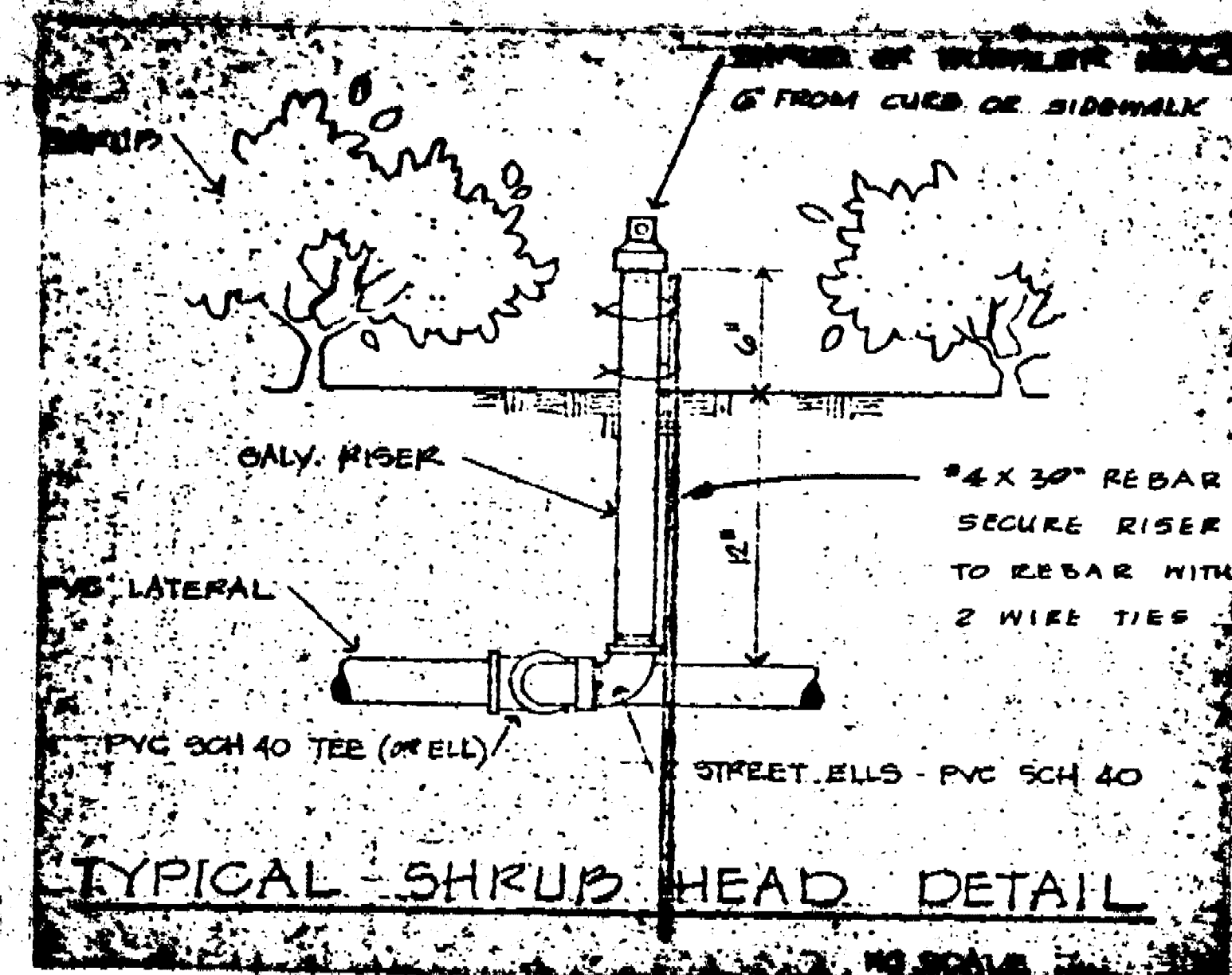

- LEGEND**
- 1" Electric Remote Control Valve - Rainbird 400-ET (See Detail)
 - Full Circle Sprinkler Flat Spray Head - Rainbird 2400 FLT-F
 - Half Circle Sprinkler Flat Spray Head - Rainbird 2400 FLT-H
 - Quarter Circle Sprinkler Flat Spray Head - Rainbird 2400 FLT-Q
 - Quarter Circle Flower Bubbler Head - Rainbird 2200-Q
 - 1" Quick Coupler - Rainbird 44 LC
 - 3 Station Antisiphon Controller - Rainbird 20-3
 - 1" Water Meter (City of Stockton) and Service Lateral Lines P.V.C. Class 165 Pipe, Typical Main Lines P.V.C. Class 200 Pipe, Typical
 - S.A.P. 711 1" Rainbird Backflow Preventer
 - Half Circle Flower Bubbler Rainbird 2200-H

CENTRAL PARKING DISTRICT
PARKING LOT
CHANNEL STREET & HUNTER STREET
ELECTRICAL & SPRINKLER PLAN
DEPARTMENT OF PUBLIC WORKS
CITY OF STOCKTON, CALIFORNIA

R. P. WELDMAN & ASSOCIATES, INC.
REGISTERED CIVIL ENGINEERS
1111 CHURCH STREET, STOCKTON, CALIFORNIA
R. P. WELDMAN
RICHARD A. WELDMAN
JULY 10, 1980

SCALE: 1"=10'
DATE: 7-10-80
PROJECT: 23123 C
CITY ENGINEER
R. P. WELDMAN

23123 C 8-14

R. P. WELDMAN & ASSOCIATES, INC.
 ELECTRICAL & SPRINKLER PLAN
 23123 C

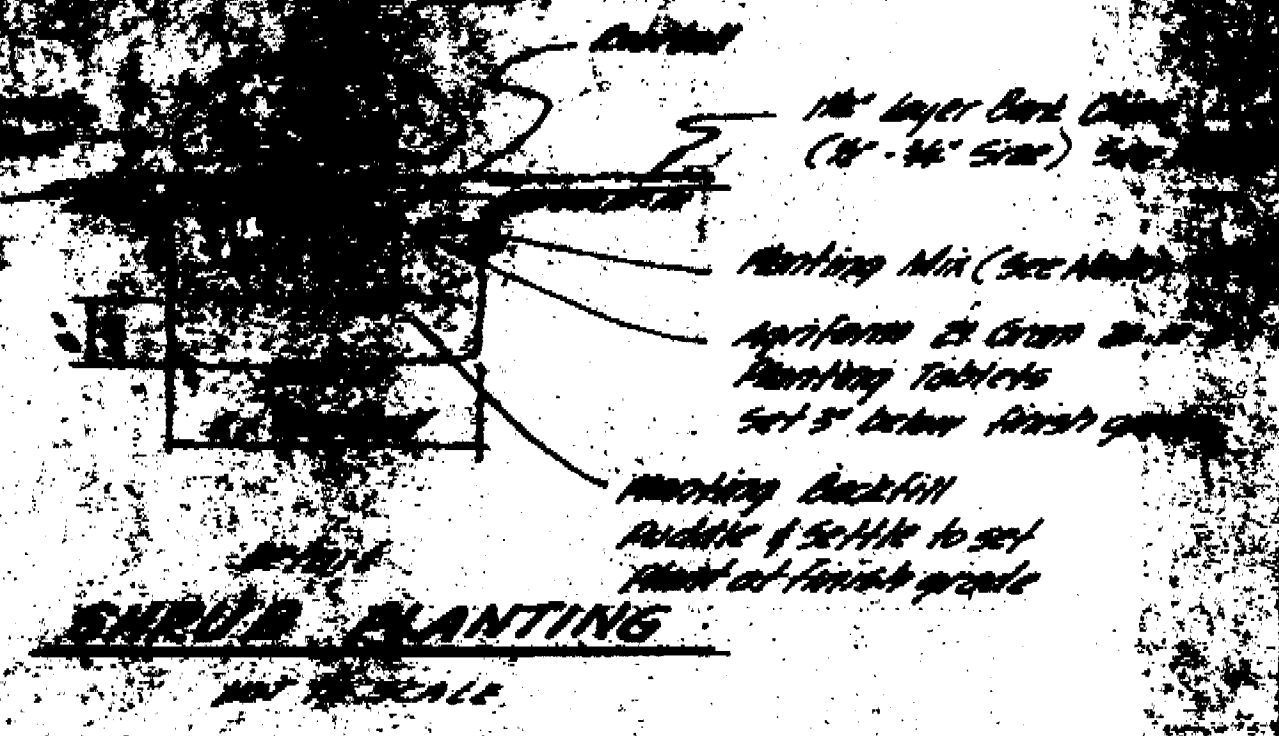
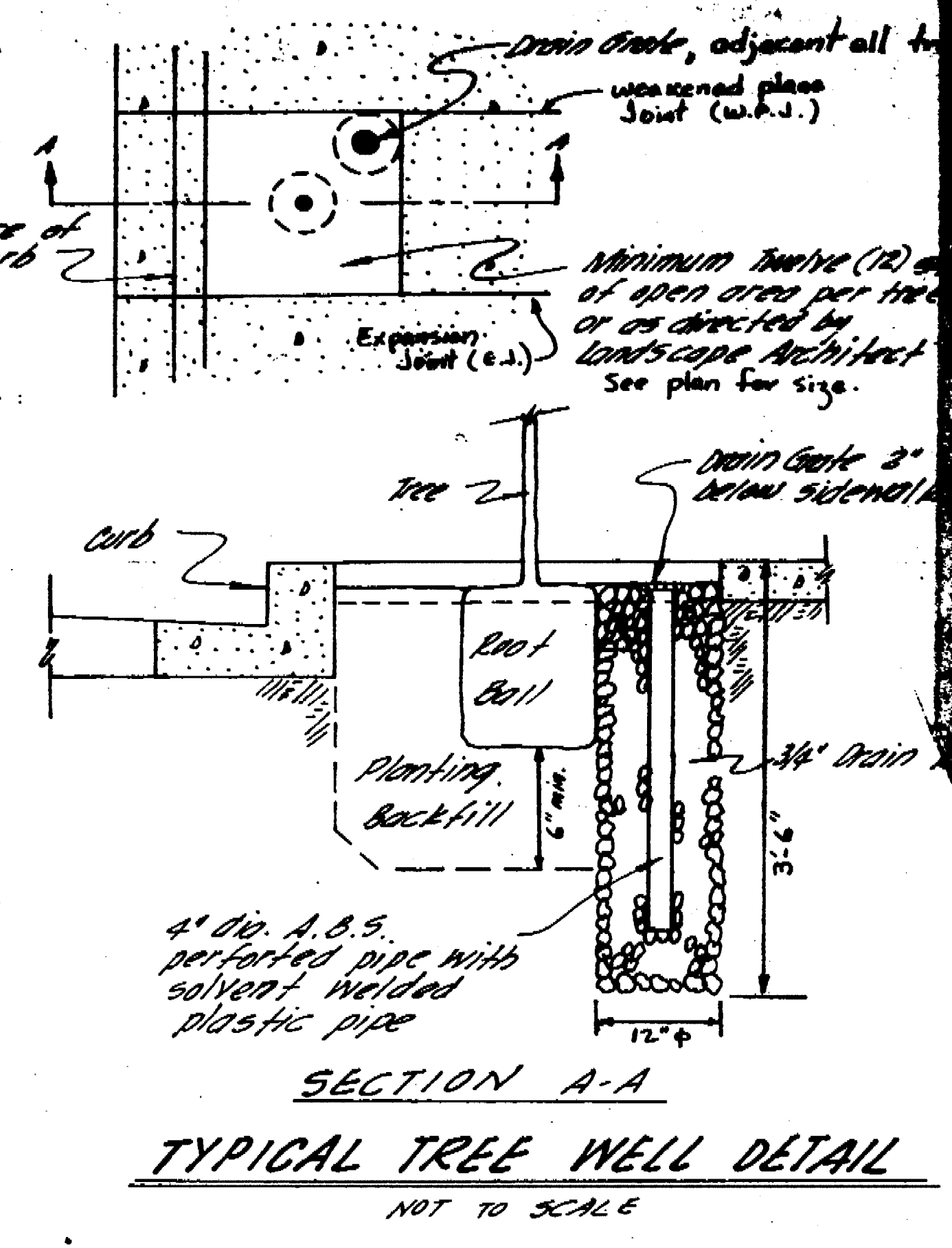
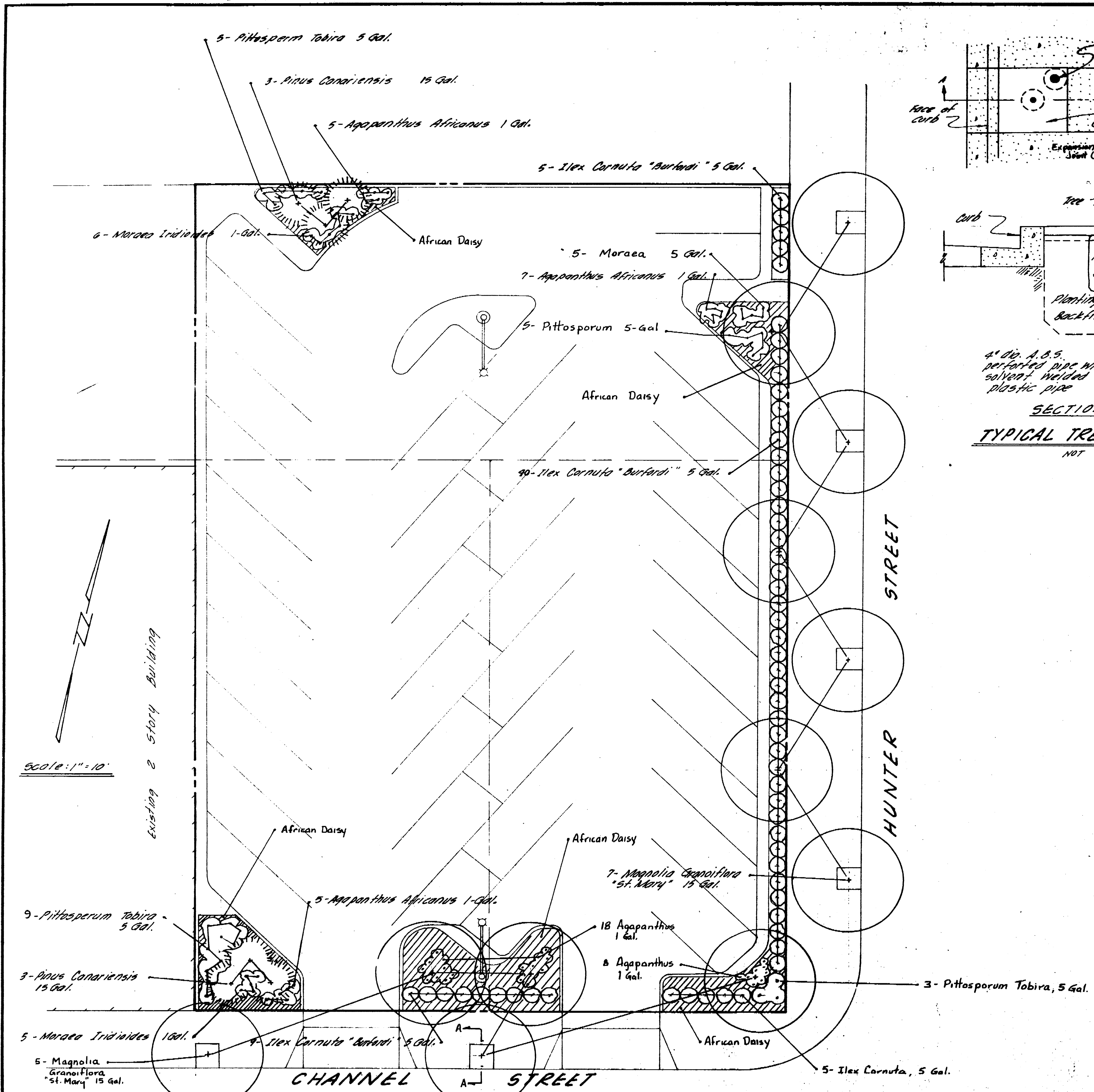

1. The Contractor shall be responsible for the proper installation and maintenance of all plants and materials shown on this plan.

2. All planting areas shall be prepared by the Contractor to receive the plants and materials shown on this plan.

3. The Contractor shall be responsible for the proper installation and maintenance of all plants and materials shown on this plan.

4. The Contractor shall be responsible for the proper installation and maintenance of all plants and materials shown on this plan.

R.P. WELDMAN & ASSOCIATES, INC.
CONSULTING CIVIL ENGINEERING
2100 SHREVELAND AVE. STOCKTON, CALIFORNIA
Ronald P. Woldman
RONALD P. WELDMAN E.C.E. NO. 10889

CENTRAL PARKING DISTRICT PARKING LOT CHANNEL STREET & HUNTER STREET LANDSCAPING PLAN		
DEPARTMENT OF PUBLIC WORKS CITY OF STOCKTON, CALIFORNIA		
SCALE: 1" = 10'	DESIGNED BY: R.P.W.	APPROVED BY: DATE: 11-22-76
DRAWN BY: D.R.B.	CHECKED BY: R.P.W.	SHEET NO.: 4
TRACED BY:		OF 2 SHEETS
		JOB NO. 129-20

Landscaping Plan
 2312.42

2312.42 6-14

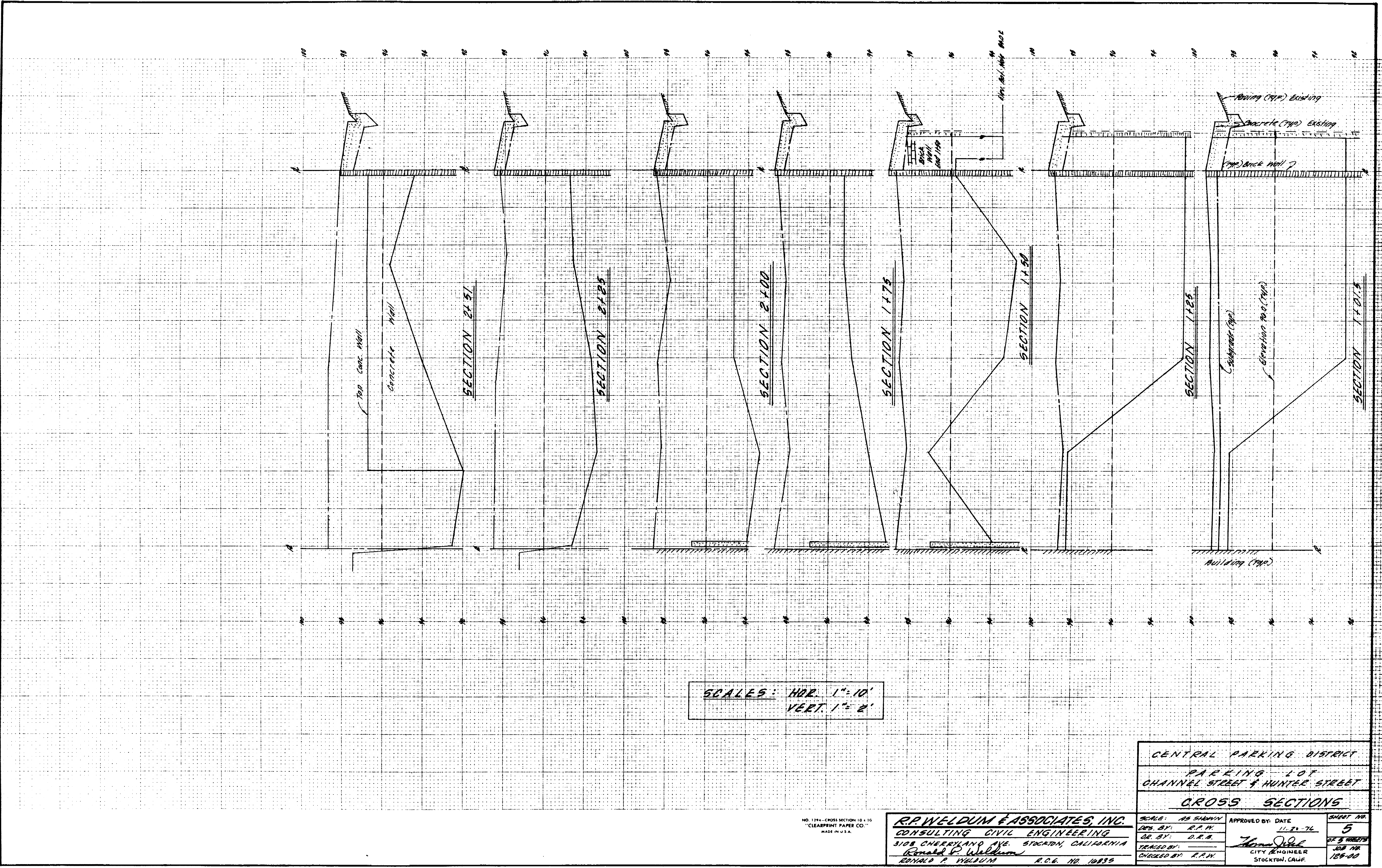

SCALES: HOR. 1"=10'
VERT. 1"=2'

CENTRAL PARKING DISTRICT
PARKING LOT
CHANNEL STREET & HUNTER STREET
CROSS SECTIONS

NO. 1294 - CROSS SECTION 10 x 16
"CLEARPRINT PAPER CO."
MADE IN U.S.A.

R.P. WELDMAN & ASSOCIATES, INC.
CONSULTING CIVIL ENGINEERING
3108 CHEERYLAND AVE. STOCKTON, CALIFORNIA
Ronald P. Weldman
RONALD P. WELDMAN R.C.E. NO. 10839

SCALE: AS SHOWN
DES. BY: R.P.W.
DR. BY: D.R.H.
CHECKED BY: R.P.W.

APPROVED BY: DATE
11.21.76
CITY ENGINEER
STOCKTON, CALIF.

SHEET NO.
5
OF 5 SHEETS
JOB NO.
188-00

2312.50-14

Boiling for STE 101 2312.50
Cross Sections

STATE BOARD OF CIVIL ENGINEERS AND SURVEYORS